

Grate

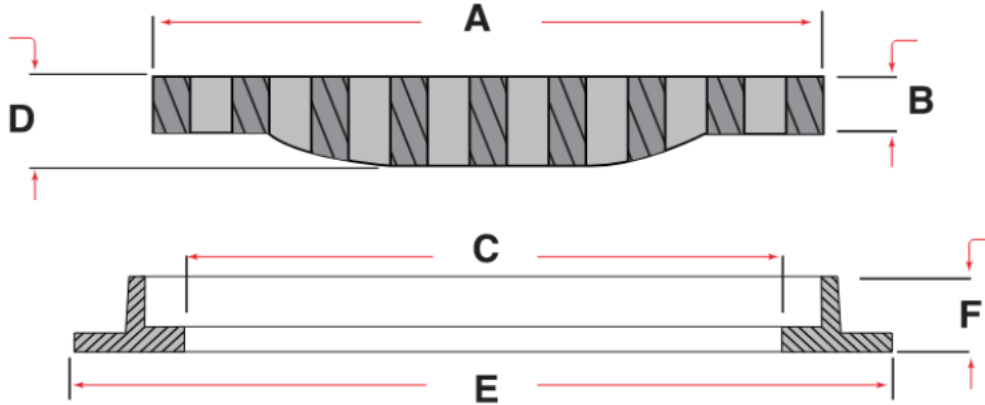

N.M	A	B	D	C	E	F	LOAD/Ton
ROUND							
GR-1031	630	50	120	600	750	100	40
GR-1032	630	50	90	600	750	100	15
GR-1024	580	80	130	550	700	100	40
GR-1025	580	80	80	550	700	100	15
GR-1026	570	63	35	540	620	75	5
SQUARE							
GS-2009	605	50	140	600	720	100	40
GS-2010	605	50	90	600	720	100	15
GS-2013-3	520	45	135	490	650	70	35
GS-2011	330	30	30	300	400	45	5
RECTANGULAR							
GRC-3026-1	1000x550	45	160	1000x450	1010x560	50	40
GRC-3013	1010x630	45	150	970x600	1120x770	75	40
GRC-3016	900x700	60	150	850x650	1040x840	85	40
GRC-3011	875x590	45	170	820x540	1000x720	72	40
TRC-4001	750x400	45	110	665x315	765x415	50	35
GRC-3018*	1350*900	45	150	1250*800	1360*910	50	40
GRC-3020	500x300	45	120	460x260	610x410	70	35
GRC-3021	500x350	45	120	460x315	610x460	70	35
GRC-3015	500x300	40	40	430x228	510x308	40	5
GRC-3016	500x200	25	25	445x150	505x210	30	5
2 Pieces Tob Lid							