

Trench

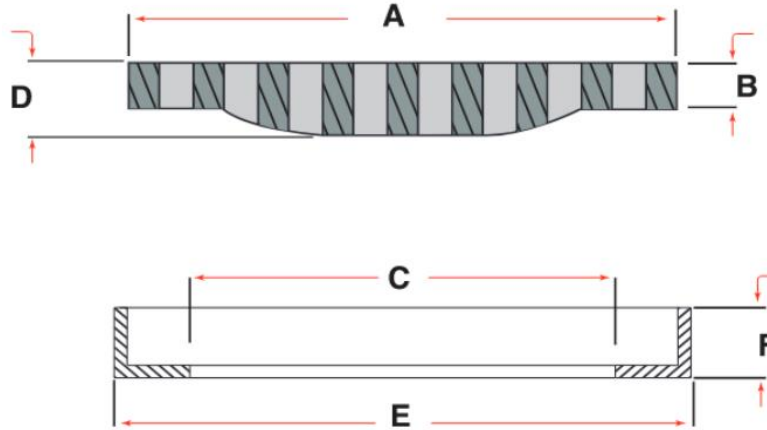

N.M	A	B	D	C	E	F	LOAD/Ton
GRC-3026-1	550	45	160	450	560	50	40
TRC-4001	400	45	110	315	415	50	35
GRC-3013	630	45	150	545	645	50	40
GRC-3018-c	665	45	150	580	680	50	15
GRC-3015	300	40	40	230	310	40	6
GRC-3016	200	25	25	150	210	30	6
GRC-3011-C	590	45	170	495	605	50	40
GRC-3012-C	300	45	120	215	315	50	35
GS-2009-C	605	50	140	500	620	60	40